

HYDRUMATIC

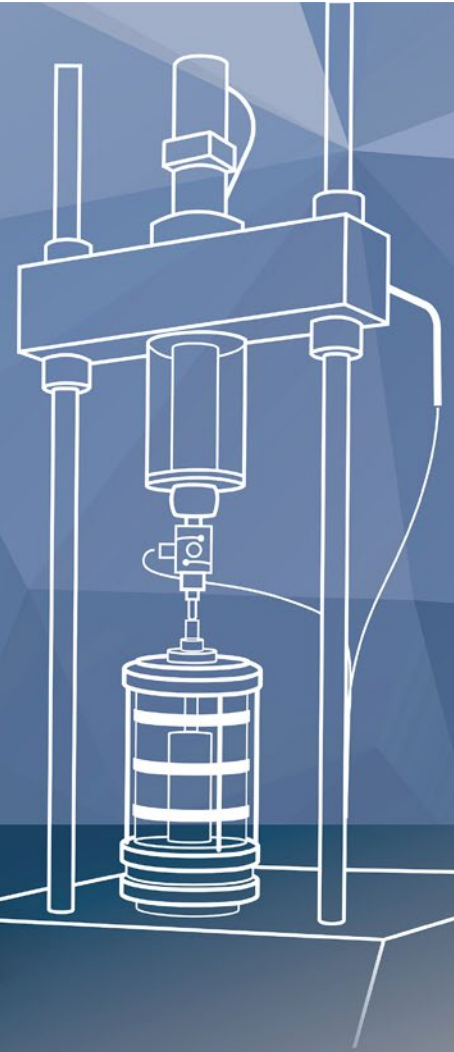

GEODATALOG 8



## Retrofitting Made Easy

Stay ahead of technology with our latest generation of flexible integrative components

# Modular by Design

Wykeham Farrance offers a flexible and comprehensive range of modular components for the retrofitting of geotechnical laboratory equipment that will help you maintain the highest testing standards without any major interruption to your daily workload.

Retrofitting equipment are beneficial to Soil Mechanics laboratories that use old triaxial systems which may cause issues with reliability, productivity and testing set-up. Our unique and exclusive modular approach enables you to future-proof your testing systems by gradually upgrading its components, allowing you to adapt to ever-evolving technologies. Quite simply, our design philosophy ensures that Wykeham Farrance machines NEVER become obsolete and facilitates a seamless transition when adopting new technologies.

A typical existing configuration includes:

## TYPICAL EXISTING CONFIGURATION

### Basic Data Acquisition

Basic data acquisition with low accuracy and poor solutions for data processing and reporting.



### Traditional Pressure Sources

Traditional pressure sources such as self-compensating mercury pots, compressed air, oil and water electric pumps, dead weight devices, etc.



### Old Measuring Devices

Manual low resolution volume-change measuring device (lower than 0.1 cc.).



### Space Hungry Systems

Driving manual pressure systems, wall panels with manual valves and air regulators must also be supplied meaning more space required in the laboratory and more time for system set-up.



### Noisy Systems

Where compressed air is implied, the external compressor produces a disturbing noise and often creates maintenance issues.



## RETROFIT CONFIGURATION

### Real-time Data Acquisition

Real-time advance data acquisition with effective resolution of 131.000 points and sampling rate up to 500 reading per channels per seconds.

### Innovative Pressure Sources

Water pressure source and volume change controller with multi-positioning, ergonomic and removable 6" Color Touch Screen controller that powers-up to two pressure lines under close loop control up to 3500 kPa or 1700 kPa.

### Innovative Measuring Device

Automatic high resolution volume-change measurement (0.001 cc) ensuring accuracy better than 0.25% for the measured value.

### Small Footprint

No need to fix panel on the wall as the Hydromatic can be easily installed vertically or horizontally with a total size of the complete system smaller than 1.5 m.

### Silent System

Air compressor no longer required resulting in a drastic reduction of the noise in the laboratory increasing focus and well-being.



Real-time Data Acquisition



Automatic Data Processing



Load, Displacement, Pressure and Volume Synchronization

**Phase 1:**  
Automatic Data Acquisition and Processing

**Phase 2:**  
Automatic Pressure and Volume Controller

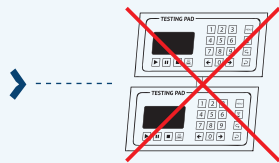
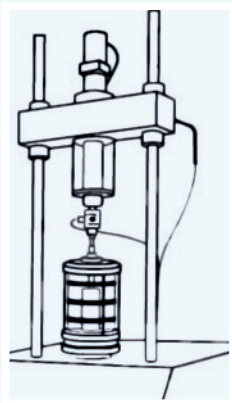

NO EXISTING DATA ACQUISITION

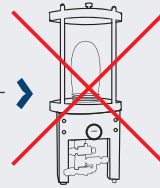

NO AIR/WATER SYSTEMS



NO VOLUME CHANGE APPARATUS



**GEODATALOG8**

**DATACOMM2**



**HYDROMATIC**

**Phase 1 Benefits**

**Streamline your testing system and save space** as the multi-channel multi-logger network connects to a single PC.

**Enjoy total peace of mind**, our new modular range is compatible with any existing laboratory instruments.

**Attain a 0 – 10 VCC or 0– 20 mA signal** effortlessly with adaptors that are compatible with existing transducers also allowing the system to perform a variety of other geotechnical tests.

**Have total confidence in your testing results**, our flexible and expandable system has up to 64 independent channels for accurate and reliable results.

**Access expert material** as the system comes complete with extensive data processing and certificates printout that include specific Wykeham Farrance MS Excel® templates, also expandable to real-time monitoring and processing.

**Phase 2 Benefits**

**Simplify and save space** as devices for compressed air, control panels and related air/water systems are no longer required.

**Eliminate noise and reduce maintenance issues** caused by the air compressor continuously running.

**Increase your maximum working pressure** to 1.7 or 3.5 MPa exceeding the traditional 1MPa systems.

**Save time and increase accuracy** as volume change measurements are now calculated directly by HYDROMATIC with high accuracy and repeatability.

**Run two pressure lines independently** thanks to a smart Touch Screen color interface.

**Real-time data acquisition and storage** with easy to set-up network connecting with GEODATALOG8.



▶ **Discover our full range of products**

We also offer completely new innovative Triaxial systems that cater for a multitude of configurations to suit your requirements. Please contact our Technical Sales team on **soil@controls.it** for practical advice and information.

Discover our full range of testing systems by visiting **www.wfi.co.uk**.



[www.wfi.co.uk](http://www.wfi.co.uk)

▶ **Wykeham Farrance Customer Care**

As a valued customer of Wykeham Farrance, you will receive continuous, expert support and advice for your instrument. Furthermore, we offer full installation and training in the correct operation of your soil testing equipment.

For support from our expert Customer Care Team, contact your local Wykeham Farrance distributor or email **soil@controls.it**. Visit our website for more information **www.wfi.co.uk**.

**Contact Us**

**Wykeham Farrance**

T +39 02 92184 1 F +39 02 92103 333 E soil@controls.it [www.wfi.co.uk](http://www.wfi.co.uk)

**CONTROLS**GROUP

**Controls Group**

T +39 02 92184 1  
F +39 02 92103 333  
E sales@controls-group.com  
[www.controls-group.com](http://www.controls-group.com)

**Italy** (HEAD OFFICE)  
[www.controlsitalia.it](http://www.controlsitalia.it)

**Iraq**  
[www.controlsmiddleeast.com](http://www.controlsmiddleeast.com)

**Spain**  
[www.controls.es](http://www.controls.es)

**Australia**  
[www.controls-group.com/ipcglobal](http://www.controls-group.com/ipcglobal)

**Mexico**  
[www.controls.com.mx](http://www.controls.com.mx)

**UK**  
[www.controlstesting.co.uk](http://www.controlstesting.co.uk)

**France**  
[www.controls.fr](http://www.controls.fr)

**Poland**  
[www.controls.pl](http://www.controls.pl)

**USA**  
[www.controls-usa.com](http://www.controls-usa.com)